

1.0 Scope

1.1 Purpose

This procedure defines the installation procedure for the CW-172001, Cessna Vent Tube Replacement.

2.0 Applicable Documents

2.1 Federal Documents

2.1.1 AC 43.13-1B Chapter 3.

3.0 Requirements

3.1 Personnel

Installation shall be performed by qualified personnel who have been certified to perform required tasks.

3.2 Required materials for installation.

Item	

4.0 Installation Procedure

4.1 Removal of existing Vent Tube Adapter.

4.1.1 Remove the screws from the leading edge wing root cover.

4.1.2 Unhook the vent hose from old vent tube adapter.

4.1.3 Remove old vent tube adapter.



4.2 Final adjustments prior to installation

4.2.1 Take the new vent tube adapter, line the hole up with the hole on the leading edge

Note: The 1" pipe should come out level when the wing is level...if it is installed incorrectly (upside down) it will point upward at about a 45 degree angle. Make sure it is level.



4.2.2 Once everything is lined up, mark your mounting holes and drill holes oversized to allow for use of tinnerman clip

Note: Every Cessna the holes seem to be in slightly different locations, so CW-172001 is slightly oversized to accommodate all Cessnas



- 4.2.3 After your holes are drilled, trim excess aluminum off, but no more than necessary to allow tinnerman clip to center over the hole you just drilled.

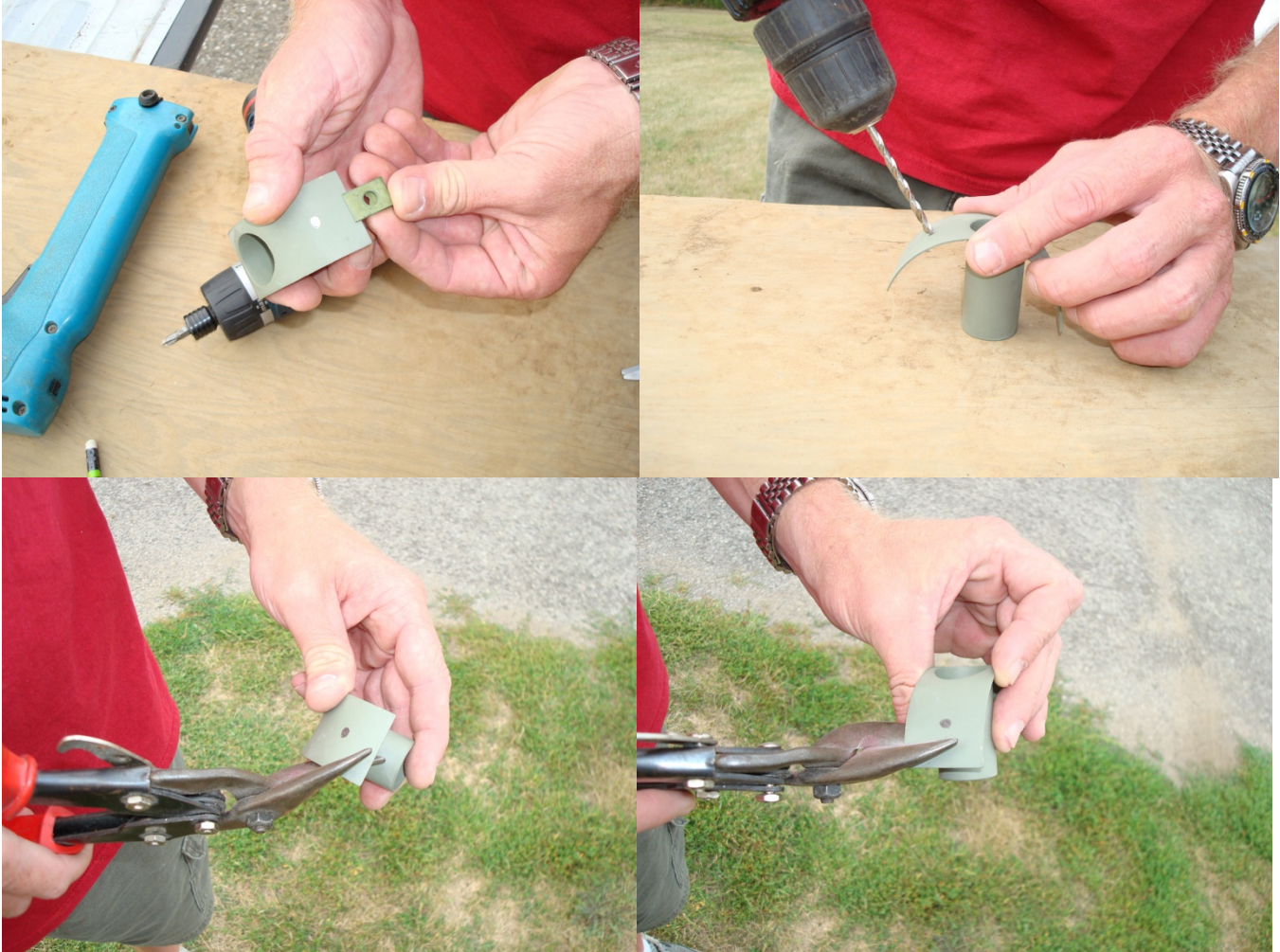

- 4.3 Final Installation of CW-172001 Cessna Vent Tube Adaptor
4.3.1 Mount to your wing root cover. Hook your vent hose back up and mount your wing root cover back to the plane



This job should take approximately ½ hour once your tools are gathered for job.

END

This document contains confidential and proprietary information and shall not be used, cited, or reproduced without written permission from Chris Wingate.