

2

1

REVISION



DENOTES REVISION

~	1/21/2010	ORIGINAL
A	3/11/10	Changed notes on jacketed conduit to Teflon
B	5/28/10	Changed notes on travel
C	2/6/2012	Reformatted

MCTLXXX4DLLL Series Dual Turn To Lock Controls

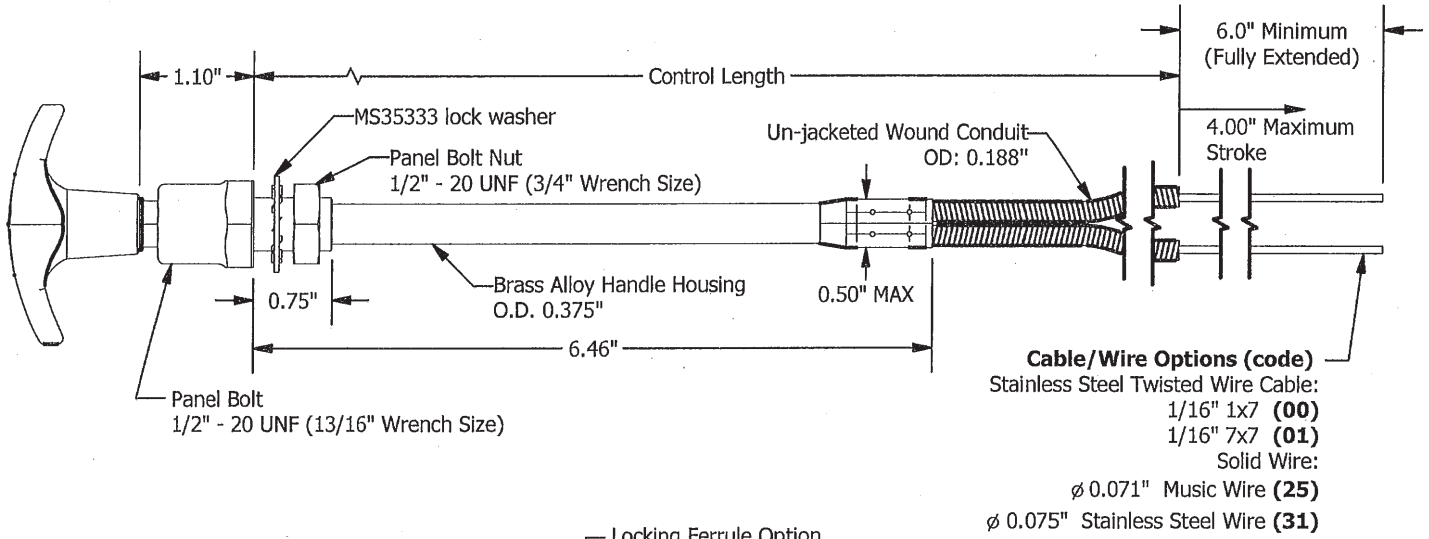

Cable/Wire Options (code)
 Stainless Steel Twisted Wire Cable:
 1/16" 1x7 (00)
 1/16" 7x7 (01)
 Solid Wire:
 ø 0.071" Music Wire (25)
 ø 0.075" Stainless Steel Wire (31)

Locking Ferrule Option
 1=Nylon (Standard)
 2=Brass (Heavy Duty)

Knob Style/Marking Option
 (see page 3)

MCTL(X)(XX)4D(LLL)-(K)

Cable/Wire Option
 See codes above

Control Length in inches

Example: Part Number **MCTL1004D048-TL** is made with a nylon locking ferrule, 1/16"-1x7 twisted cable, is 48 inches long, and fitted with a T-Handle marked with a turn to lock design.

- Travel (Stroke):** 4 inches maximum
- Maximum Work Loads:** Push: ~10 lbs* Pull: ~25 lbs
- Minimum Locking Force:**
 - Standard (Nylon Ferrule): ~30 lbs
 - Heavy Duty (Brass Ferrule): ~55 lbs
- Operating Temp:** -65 °F to 450 °F
- Note:** Maximum operating temp of knob 250 °F

*Push loads apply to controls with solid wire only and depend on wire diameter, length of trimmed wire (unsupported by conduit), geometry of the wire rigging, and the actuator configuration.

Project Engineer: <i>[Signature]</i>	Engineering Manager: <i>[Signature]</i>	Quality Manager: <i>[Signature]</i>	Manufacturing Manager: <i>[Signature]</i>
Date: 2/8/12	Date: 2/13/12	Date: 2-14-12	Date: 2-13-12



Title: **McFarlane Turn to Lock Controls**

Size: **A** Scale: **NA** Drawn: **BWM** Sheet: **1** of **3**

Part Number: Drawing Number: **6426** REVISION

C

2

1

MCTLXXXX-LLL Series Single Turn To Lock Controls

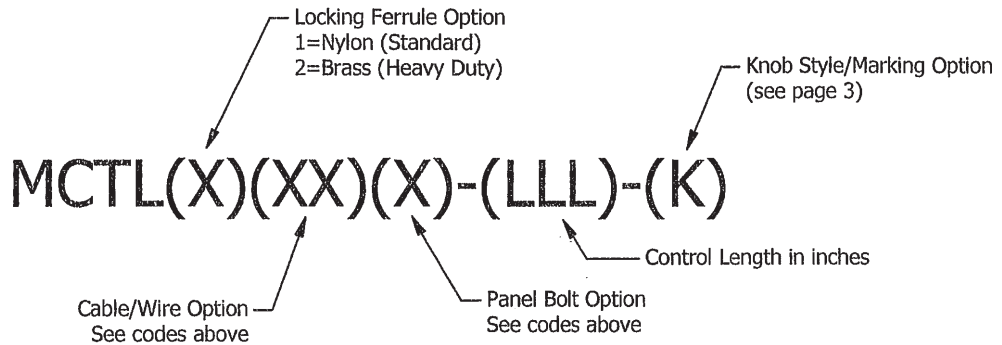
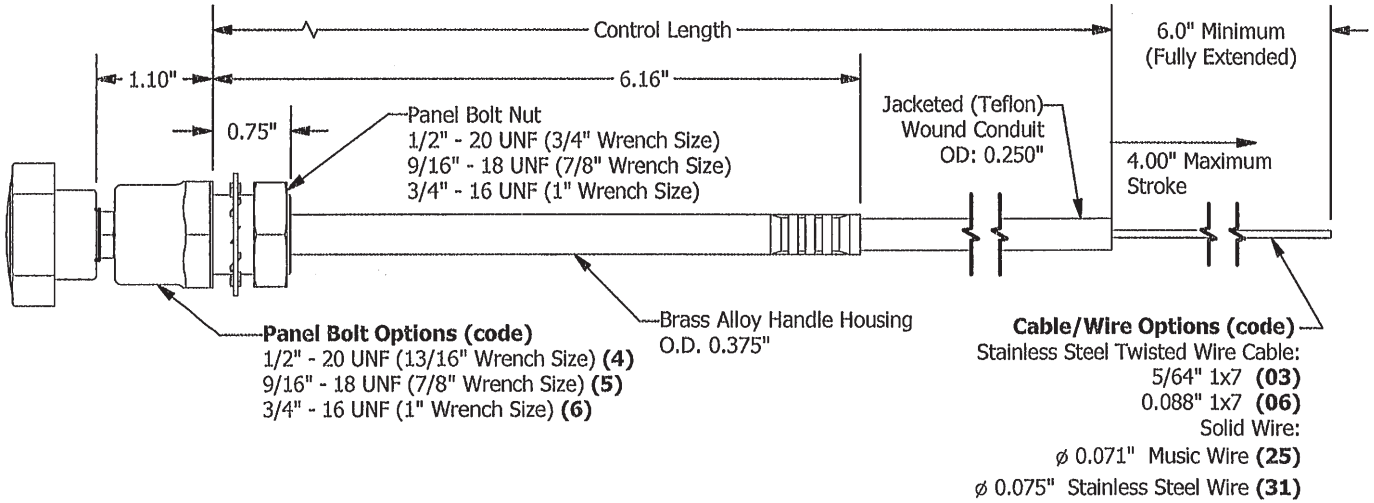

Example: Part Number **MCTL2254-072-F** is made with a brass locking ferrule, .071 dia music wire, 1/2-20 panel bolt, is 72 inches long, and fitted with a plain fluted knob.

- Travel (Stroke): 4 inches maximum**
- Maximum Work Loads: Push: ~10 lbs* Pull: ~25 lbs**
- Minimum Locking Force:**
 - Standard (Nylon Ferrule): ~30 lbs**
 - Heavy Duty (Brass Ferrule): ~55 lbs**
- Operating Temp: -65 °F to 450 °F**
- Note:** Maximum operating temp of knob 250 °F

**Push loads apply to controls with solid wire only and depend on wire diameter, length of trimmed wire (unsupported by conduit), geometry of the wire rigging, and the actuator configuration.*

		McFarlane Aviation, Inc. 696 East 1700 Road Baldwin City, Kansas 66006	
Title: McFarlane Turn to Lock Controls			
Size: A	Scale: NA	Drawn: JB	Sheet: 2 of 3
Part Number:		Drawing Number: 6426	
			C

2

1

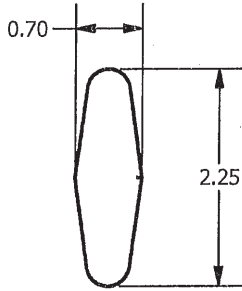
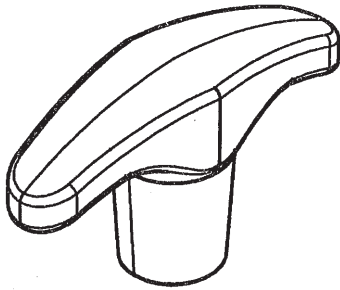

T-Handle

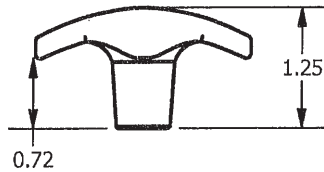

Code	Marking
T	Plain (no marking)
TL	Turn to Lock
TC	Choke Lock

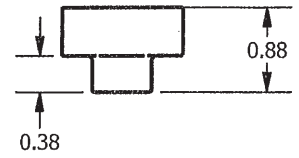
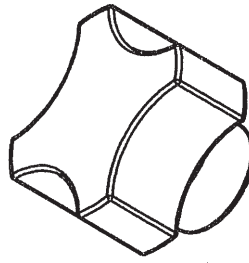

Four Prong

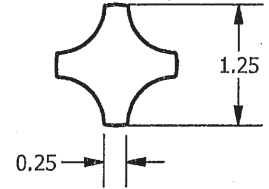

Code	Marking
P	Plain (no marking)
PL	Turn to Lock

B

B

A

A

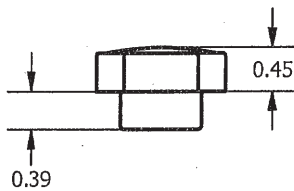
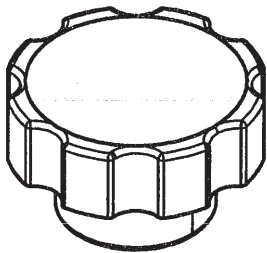

Fluted

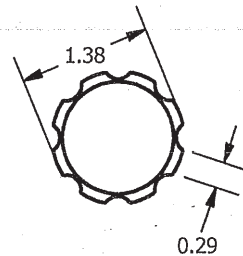

Code	Marking
F	Plain (no marking)
FL	Turn to Lock
FH	Cabin Heat Lock
FA	Airbox Lock

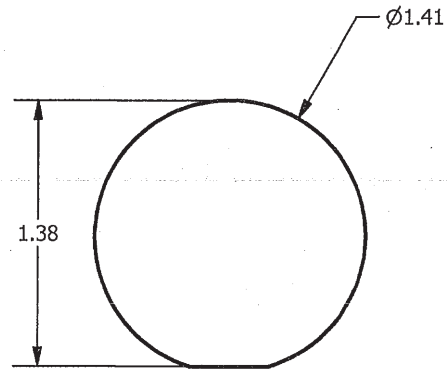

Ball

Code	Marking
B	Plain

Custom markings are available



McFarlane Aviation, Inc.
696 East 1700 Road
Baldwin City, Kansas 66006

Title: **McFarlane Turn to Lock Controls**

Size: **A** Scale: **NA** Drawn: **JB** Sheet: **3** of **3**

Part Number: Drawing Number: **6426** REVISION

C

2

1