



McFarlane Aviation, Inc.
682 E. 1700 Road, Building C
Baldwin City, KS 66006

McFarlane Aviation Products

Custom Flight Control Cable Order Form

800-544-8594
(785) 594-2741
Fax (785) 594-3922
www.mcfarlaneaviation.com
customparts@mcfarlaneaviation.com

Step 1: Define Cable Type

Cable Diameter: 1/16 3/32 1/8 5/32 3/16 7/32 1/4

Cable Construction: 7 x 7 7 x 19

Cable Composition: Stainless Steel Galvanized

Corrosion Protection per MIL-PRF-16173 Class 1, Grade 1 Yes No

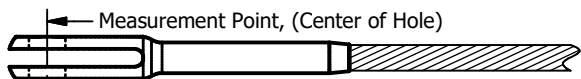

MS20658 Fork Terminal End 1 End 2

MS20667 Fork Terminal End 1 End 2

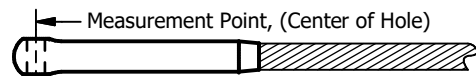

NAS287 Chain to Cable Terminal

End 1 End 2

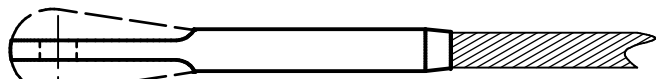

Measurement Point, (Center of Hole)

MS20668 Eye Terminal End 1 End 2

Step 2: Check Each Type of Terminal Needed

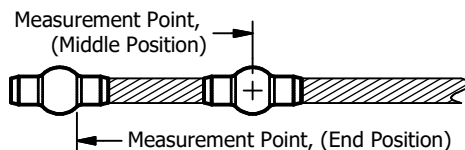

MS20663C Double Shank Ball Terminal

End 1 End 2 Middle

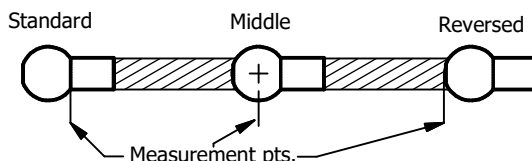

MS20664C Single Shank Ball Terminal

End 1 Std. Rev.* End 2 Std. Rev.*

Middle with shank facing End 1 End 2

* Unless otherwise specified, load ratings for reversed terminals shall be the same as the equivalently sized BM2487 terminal (see Table 1)

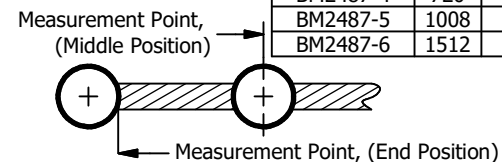

BM2487 Plain Ball Terminal

End 1 End 2 Middle

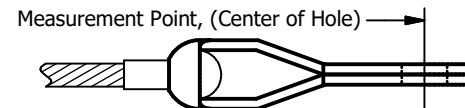

NAS1435E Strap Eye w/ MS20664C Ball

End 1 End 2



NAS1435K Strap Fork w/ MS20664C Ball

End 1 End 2



MS21259 Stud End End 1 End 2 Thread Type LH RH

MS21260 Turnbuckle End End 1 End 2

Thread Type LH RH Short Terminal Long Terminal

Step 3: Indicate Lengths (example shown below see terminals above for actual measurement point)

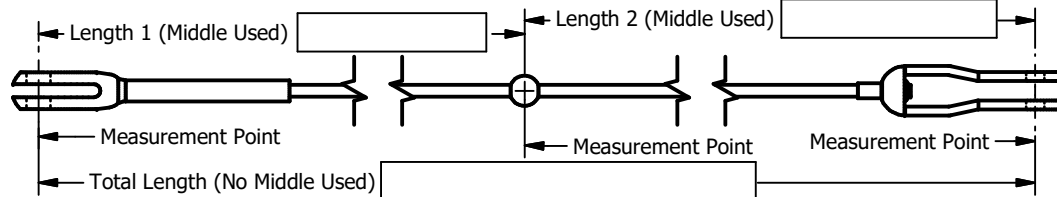

I REQUEST MCFARLANE AVIATION, INC. TO MANUFACTURE A PART PER THE DATA ON THIS FORM. I UNDERSTAND THAT I AM SOLELY RESPONSIBLE FOR ENSURING SUITABILITY OF THE PART FOR MY INTENDED APPLICATION. THIS DATA WAS EITHER PROVIDED BY ME OR DEVELOPED JOINTLY WITH MCFARLANE AVIATION, INC. ON MY BEHALF AND WITH MY PARTICIPATION AND SUPERVISION. I UNDERSTAND THAT UNLESS OTHERWISE AGREED, MCFARLANE AVIATION, INC. MAY USE THIS DATA FOR ANY PURPOSE. I UNDERSTAND THAT THIS PART IS NOT FAA APPROVED. AND I CERTIFY THAT IF THIS PART IS TO BE INSTALLED ON A TYPE-CERTIFICATED AIRCRAFT IT WILL BE INSTALLED IN FULL COMPLIANCE WITH ONE OF THE EXCEPTIONS LISTED IN 14 CFR 21.9(A).

Signature: _____ Date: _____

Customer Name: _____ Contact Name: _____

Address: _____

Email: _____

Phone: _____ Aircraft Make: _____

Fax: _____ Model: _____

Special Requirements/Notes:

Additional sheet(s) attached

Notes:

1. Cable used for all assemblies will conform to MIL-DTL-83420 Type 1.
2. Terminals will be swaged onto the cable in accordance with MIL-DTL-6117.
3. Each cable assembly will be pre-stretched and proof loaded with a load equal to 60% proof load applied as per table 1 or MIL-DTL-6117 as applicable. A 100% destructive load will be applied to a test cable of each lot.
4. Measure terminals as indicated with Measurement Point, as dependent on applicable location and orientation.
5. Certification to specifications listed above are included with each order.
6. Alternate forms are available for continuous loop cables or with NICOPRESS ends.